

TONS and TONS of STEEL...

In the last six months, we put over 5,000,000 lbs. of steel through our hefty "Finns," as we punched, bent, welded and otherwise fabricated our way to a year that would see over 35,000 stoves roll off of our finish line.



And a few good people...

We make it a point to "hang on to the good guys," and we have folks with excellent skills that range from creating CAD drawings to operating CNC brakes and punches to welding or just keeping our finish line running smoothly. Many of our employees have "worked up through the ranks" over the course of 10, 15 or 20-plus years with us.

A history of 'fabwork'...

England's Stove Works was started in 1975 by Bob and Ron England, literally in their own backyard.

Today, we're proud to remain family owned, and we're still in the England's "backyard" of Monroe, VA.

Bob and Ron were pipe welders by trade, and E.S.W. has grown from just a few employees fabricating simple but durable wood stoves, to a well-respected corporation that produces tens of thousands of wood, pellet, gas and corn stoves - stoves that are distributed throughout America.

Since 1975, Metal Fabrication has been at the heart of every step we take in crafting our fine product - we begin with plate steel and perform every step of fabrication at our facility in Monroe. Our dedicated team has years of experience in metal fabricating, and we can complete large or small jobs that involve anything from punching and bending to welding, finishing and delivery of product. And our rates are truly among the most competitive available.



Proudly Made in the U.S.A.!!

England's Stove Works, Inc.

"Celebrating 30 Years"

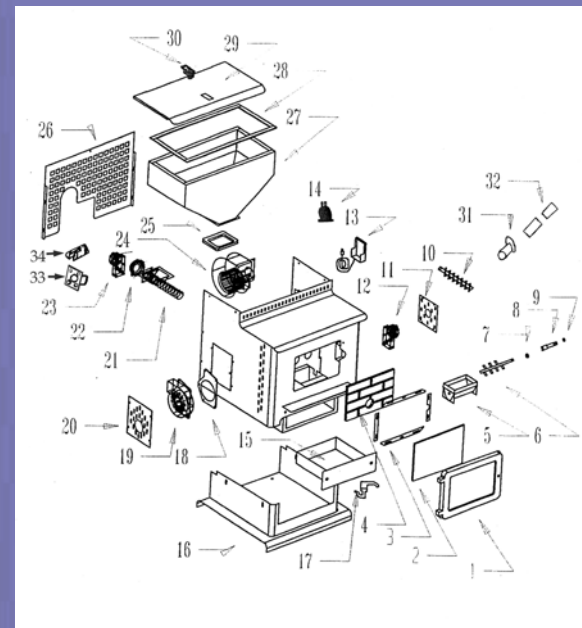

England's Stove Works, Inc.
589 South Five Forks Rd.
P.O. Box 206
Monroe, VA 24574

(800) 516-3636

www.englishstoves.com/metal

Quotes: Chris Terrell, ext. 152
cterrell@englishstoves.com

While we understand that Capabilities extend far beyond a listing of equipment, we figure you'd still like to know what we have to offer...

CNC Machinery: All of our major equipment is CNC operated,* allowing for the “bells & whistles” that CNC offers, such as automatic backstops, etc.

Finn-Power Turret Punches: Our F-5 and our C-5 Finn-Power Turret Punches each have the same specifications: six auto-index stations, 23 fixed stations; the ability to punch sheets up to 100” long and 50” wide; and the ability to handle metals up to 3/16” thick. They handled over 5,000,000 lbs. of steel in one six-month period last season.

Accurpress Press Brakes: We have two matching 100-ton Press brakes, each with a 6’ bed and 4’ backstop.

Toyokoki Press Brakes: We also have two Toyokokis. One is an 80-ton, with a 8’ bed and Euro style punches, and the second is a 55-ton unit that has a 6’ bed and Euro style punches.

Pacific Press: Our 225-ton Pacific Press has a 10’ bed and end horn, for really heavy jobs.

Pacific Press Pressformer: Our massive pressformer was at one time the largest in the state of Virginia. Its ram platform is 24” x 24”, and its table is 48” x 40”.

Wheelabrator: Every one of our stoves is put through our multidirectional wheelabrator. When it comes to steel shot-blasting, this machine is quite efficient. Its two 96” rotating swing tables can handle alot of metal (such as several of our stoves on each table) in one run.

Accurshear Shear: This shear has a 10’ table length, pneumatic sheet support fingers and quite possibly the most true squaring arm in the world.

MORE! A few more of our many proven capabilities include: 26 MIG welding stations running off of pre-mixed Argon CO2; Hyd-Mech liquid-cooled band saws; a Vicon 5’ x 5’ plasma table; a 35-ton Geka Iron Worker; proven powder-coating vendors; loads of forklifts for maximum material handling; and our “sister” company, Englander Transport, with coast-to-coast delivery.

**Our Pacific Press is the one exception, it is not CNC*